

## Switch drawings

Dimensional tolerance is ± 0.2mm

## Number Description

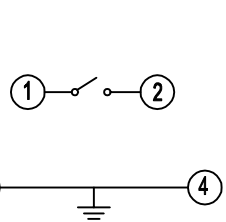
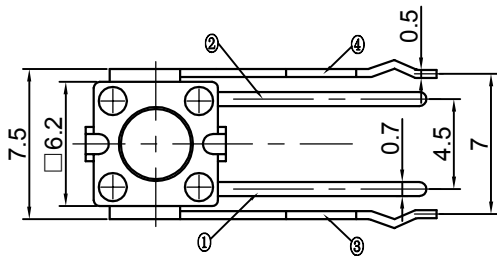
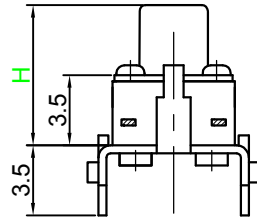
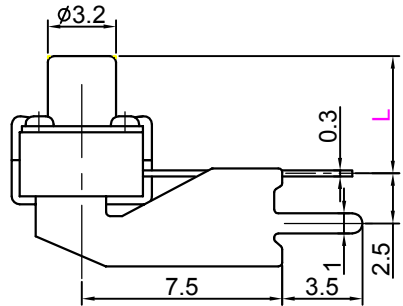

CIRCUIT DIAGRAM

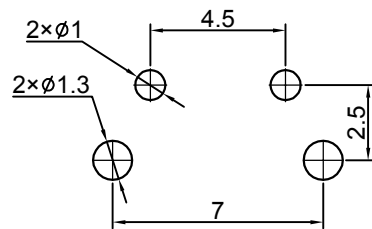

P.C.B. LAYOUT

L H-1.15

H	4.3	4.5	4.8	5.0	5.5	6.0	6.4	6.6	7.0	7.3	7.5
H	8.0	8.5	9.0	9.5	10.0	10.5	11.0	11.5	12.0	12.5	13.0
H	13.5	14.0	14.5	15.0	15.5	15.6	16.0	16.5	17.0	17.5	18.0
H	18.5	19.0	19.5	19.7	21.0	22.0	23.0	23.5	25.0	26.0	29.0



Switch height (mm)			
043=4.3	080=8.0	135=13.5	185=18.5
045=4.5	085=8.5	140=14.0	190=19.0
048=4.8	090=9.0	145=14.5	195=19.5
050=5.0	095=9.5	150=15.0	197=19.7
055=5.5	100=10.0	155=15.5	210=21.5
060=6.0	105=10.5	158=15.8	220=22.0
064=6.4	110=11.0	160=16.0	230=23.0
066=6.6	115=11.5	165=16.5	235=23.5
070=7.0	120=12.0	170=17.0	250=25.0
073=7.3	125=12.5	175=17.5	260=26.0
075=7.5	130=13.0	180=18.0	290=29.0

Strength (lifespan)	Cover (Salt spray time)
3=180gf(500K)	2=Ferrum with Nickelplate (8H)
5=280gf(300K)	5=Ferrum with Nickelplate (8H)
Contact	
1=Cu silvering	

## SPECIFICATIONS

Funtion:	Momentary action
Contact Arrangement:	SPST, Normally Open
Termination:	THD version

## Environmental

Operating Temperature:	-25~+70℃
Relative Humidity:	(40℃) ≤70%

## Electrical

Contact Rating:	50mA 12V DC
Dielectric Strength:	250VAC /1min
Contact Resistance:	100mΩMax.
Insulation Resistance:	100MΩMin.
Travel:	0.25±0.1mm

## Mechanical

Actuation Force:	Optional
Life Expectancy:	Optional

## Materials

1.Stem:	Optional
2.Cover:	Optional
3.Contact:	Optional
4.Holder:	Optional
5.Terminal:	Ag plating Au plating
6.Support:	Nonoptional

